

SPECIFICATIONS

Model	ES-FW810W	ES-FWX812W	ES-FW1010W
Dimensions	596(W)x565(D)x850(H)mm	596(W)x565(D)x850(H)mm	596(W)x635(D)x850(H)mm
Maximum mass of wash cloth	8kg	8 kg	10 kg
Power Source	220 ~50Hz	220 ~50Hz	220 ~50Hz
Rated washing water	68 L	56L	77L
Power Consumption(WASH)	150W	140W	100W
Power Consumption(SPIN)	300W	200W	320W
Power Consumption(WARM)	1800W	1800W	1800W
Maximal Input Power	2000W	2000W	2000W
Required Water Pressure	0.03MPa-0.8MPa	0.03MPa-0.8MPa	0.03MPa-0.8MPa

Model	ES-FWX1014W
Dimensions	596(W)x635(D)x850(H)mm
Maximum mass of wash cloth	10 kg
Power Source	220 ~50Hz
Rated washing water	60 L
Power Consumption(WASH)	150W
Power Consumption(SPIN)	300W
Power Consumption(WARM)	1800W
Maximal Input Power	2000W
Required Water Pressure	0.03MPa-0.8MPa

Front Load Washing Machine

ES-FW810W / ES-FWX812W / ES-FW1010W
ES-FWX1014W

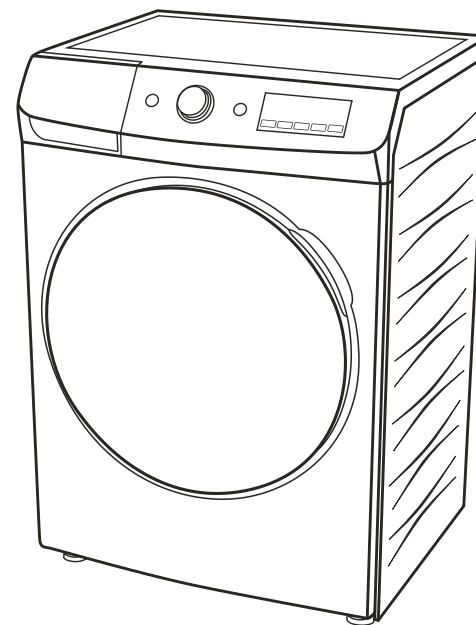

Before operating this washing machine, please read these instructions carefully and completely.

CONTENTS

SAFETY NOTICE - - - - -	2
NAME OF PARTS - - - - -	3
ACCESSORIES - - - - -	3
LOCK AND UNLOCK THE DOOR - - - - -	4
USAGE INSTRUCTION FOR DETERGENT CASE - - - - -	4
NAMES AND FUNCTIONS OF CONTROL PANEL - - - - -	5~6
NORMAL USAGE - - - - -	7
HOW TO USE THE WOOL PROGRAM - - - - -	8
HOW TO USE THE BLANKET PROGRAM - - - - -	9
HOW TO USE THE START DELAY COURSE - - - - -	10
COURSE CHOOSING GUIDE - - - - -	11
CARE AND MAINTENANCE - - - - -	12 ~ 13
VARIOUS FUNCTIONS	
CHILD LOCK FUNCTION - - - - -	14
HOW TO DRAIN REMAINING WATER - - - - -	14
HOW TO DELETE THE END BUZZER - - - - -	14
ADDING CLOTHES MIDWAY - - - - -	14
WASHING TIPS - - - - -	
NO TROUBLE CONDITIONS - - - - -	15
TROUBLE SHOOTING GUIDE - - - - -	16
INSTALLATION INSTRUCTIONS - - - - -	17 ~ 18
SPECIFICATIONS	



SAFETY NOTICE (be sure to observe)

■ To protect the user and other people's health and property, be sure to observe the following safety notice.



⚠ WARNINGS

please read this part of substance carefully for proper operation before using your machine.

● The precautions stated here are classified as "Warning" and "Attention" according to the damage and the emergency caused by misoperation, and are described respectively in line with the marks below.

 Warning	With no respect to mark, the misoperation may cause death or GBH.
 Attention	With no respect to mark, the misoperation may cause body harm or object damage.

		
This mark indicates the content of warning or attention.	This mark indicates the prohibited action.	This mark indicates the compulsory action to be carried out.

 Warning	
<p> ● Dismantling, repair or alterations should only be carried out by professional technician as otherwise you may be subject to electric shock, may cause fire or get injured.</p> <p>● Electricity supply must be unplugged with dry hands. Otherwise, this may cause electric shock.</p> <p>● Damaged or loosen wire or plug should not be used. Otherwise electric shock, short circuit or fire may take place.</p> <p>● Do not damage wire. Do not damage or alter the wire forcibly bend, pull twist or handle the wire. Beside, please do not put weigh on or trap the wire. Damage of wire may case electric shock or fire.</p> <p>● Do not put water in direct contact with the unit during maintenance and repair. This may cause short circuit or electric shock.</p> <p>● Do not put gasoline, benzine, alcohol, thinner of fabrics with these stains into or near to the washing machine. To prevent fire or explosion which may cause injuries.</p>	<p>● This washing machine is equipped with the electricity wire with bielectrode grounding socket. The creepage protector shall be used if possible. To prevent electricity leak which may cause injuries.</p> <p>● Please use the single socket with special voltage and current matched with plug marked specification. The share of the same socket with other electric appliances may cause fire due to excessive.</p> <p>● Thoroughly wipe the power plug when dirt is adhering the prong or around the base of the prong. Failure to do so may cause a fire.</p> <p>● Washing machine should not be installed in humid place or in places exposed to wind and rain. Otherwise, electricity leak causing electric shock or fire may occur.</p> <p>● This washing machine is strictly prohibited to get close to the locations with candle, mosquito-repellent incense, dog-end or other kinds of open flame. To avoid injuries caused by the lock damage.</p> <p>● Do not operate the machine when there is gas leak.</p>

⚠ WARNINGS

- Keep child away from the washing spinning basket and do not place box or shelves next to the washing machine.

children may fall into the basket resulting in injuries.

This appliance is not intended for use by persons (including children) with reduced physical, sensory or mental capabilities, or lack of experience and knowledge, unless they have been given supervision or instruction concerning use of the appliance by a person responsible for their safety.



Prohibited

- The glass door becomes hot in process of high-temperature washing. Do not touch the door when the machine is on, especially children.
- If you need to open the door during high-temperature washing program, wait until the temperature drop to safe standard, and the door unlocked automatically.
- Packing material may be dangerous to kids, please keep all packing material (plastic bag foam etc) far away from the kids.



Prohibited

⚠ Attention

- Do not pull the wire from the socket when unplugging the unit.

To avoid electric shock or fire cause by short circuit may result.



Prohibited



- Please unplug the unit when not using the unit for a long period of time.

Electric shock or leakage may occur due to deformation of plastic parts of the unit.

- Electricity supply must be unplugged with dry hands during maintenance and repair.

Otherwise, electric leakage causing injuries may occur.

- If the power cord or supply cord is damaged, the manufacturer or its service agent or similarly qualified person must replace it in order to avoid a hazard.

- Water of above 50°C should not be used for washing.

Electric shock or leakage may occur due to deformation of plastic parts of the unit.



Prohibited

- Do not wash, rinse and spin the water proof fabric or cloth.

Sleeping bag, raincoat, cover of skiing, utilities, bicycles, cars and motors. Otherwise may lead to injury by abnormal vibration during spinning or damage the washing machine, wall, floor and clothes.



Prohibited

- Do not stand on or put weight on the top of the unit.

Otherwise, deformation and damage may result causing injuries.



Prohibited

- Two people are required in moving or transportation.

- Keep hands and feet away from the bottom of the washing when it is motion.

Ports in motion beneath the unit may cause injuries.



Prohibited

- Check water supply hose connection by turning on the water before washing. To prevent damages caused by possible water leakage due to loosen screw or not tightly.

- The new hose-sets supplied with the appliance are to be used and that old hose-sets should not be reused.
- Do not block the ventilation openings on the bottom of washer by carpeting when the washer is installed on a carpeted floor.

- Please turn off the water tap when not using the unit.

To prevent damages caused by water leakage.



Water leakage
Water supply hose should be tightly screwed to the unit. Failure to do so may result in water leakage. Used for a long period of time, the unit may result in water leakage caused by loosen union nut. So please check it in time and screw tightly again.

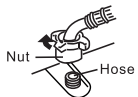

Nut Hose

NAME OF PARTS

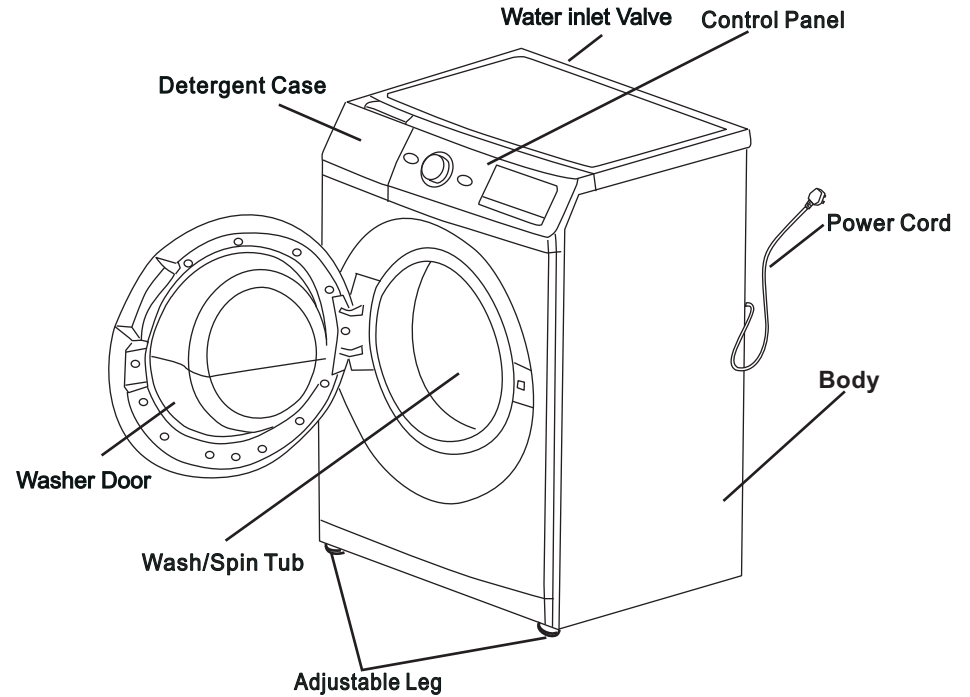

ACCESSORIES

Instruction manual	Water Supply Hose	Lid (4Piece)	Spanner

INSTALLATION INSTRUCTIONS

Transportation

Two people are needed to carry the machine. One person on one side carries the machine by holding the machine feet.

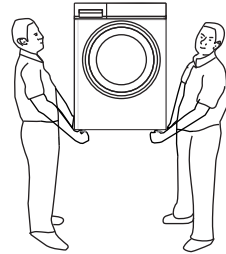

Location of washer

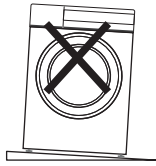

1. On the sloping ground

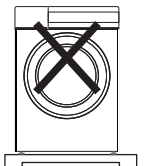

2. On the platform and the bracket

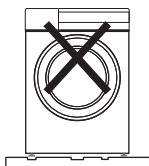

3. On the concavo - convex ground

Washing machine must be installed on the ground which must be hard, flat and skidproof. Please do not lay the washing machine on the soft blanket or wooden floor. It is forbidden to lay the washing machine on the platform or the bracket.

Remove the bolt used to fix the machine in transportation

To protect the machine in transportation, there are 4 bolts inserted into the inner part of the machine. Remove these bolts before use. (otherwise there will be strong shock, noise, and disfunction in spin process.)

1. Unscrew the bolts that are fixed before transportation by spanner(4 bolts)
 2. Remove the bolts horizontally.
 3. Fit the lid into the holes.
- Let the sales force or professional maintenance worker to install the machine.
 - Keep the dismantled bolts carefully, you will need them in house moving.
 - As the picture shows, please be sure to confirm that the base protection device is not stuck at the bottom of the washing machine before use, otherwise it will affect the usage of washing machine.

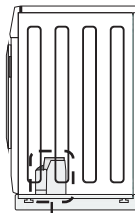
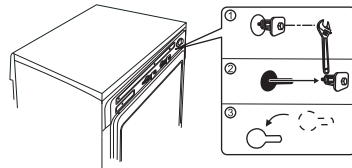

Base protection device

Adjust the machine horizontally

There will be strong shock, noise, and disfunction in operation if the washing machine is not steadily installed. Please adjust the front adjustable Leg.

Methods are as follows:

1. Check whether the washer is on a level surface using a plumb line as shown in the figure besides.
- The washer is on level ground floor if the Frame line of washer is parallel with the plumb line.
2. Adjust the Adjustable Leg of washer if necessary to make the washer level as shown in the figure besides.
3. Put your hands on the washer diagonally, press and shake the washer slightly to make sure that the washer is steady.

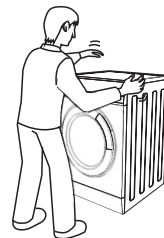
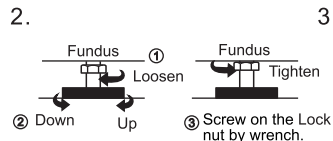
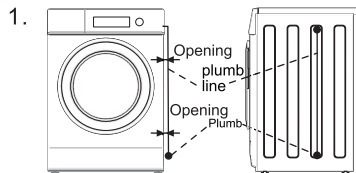

INSTALLATION INSTRUCTIONS

How to Attach the Universal connector

1. Loosen the four screws and slide the top of the Universal connector (section A in the figure) onto the faucet. Then, securely tighten the four screws provided with the Universal connector by using a screwdriver to secure the top of the joint to the faucet.
2. Remove the CAUTION label from the Universal connector.
3. Turn the male coupler on the joint (section B in the top of the joint (section A in the figure).

- The appliance is to be connected to the water mains using new Water Supply Hose and Universal connector Joint and old hose-sets should not be reused.
- The new hose-sets supplied with the appliance are to be used and that old hose-sets should not be reused.

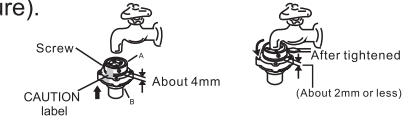

CAUTION:

If outer diameter of faucet is larger than calibre of the Joint Ring, loosen the four screws and remove the Joint Ring from the Universal connector.

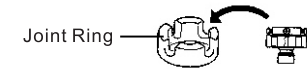

Installing Water Supply Hose to the Washer

Turn the nut clockwise till the nut turned tight while holding the hose.

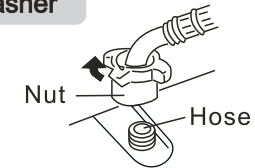

Turn the nut counterclockwise after turning the faucet off when you want to detach the water supply hose.

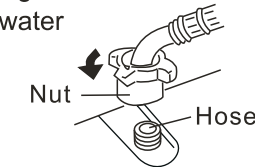

Connect of drain pipe

1. Put the pipe on the back of washer when it is not using. (as show in picture 1).
2. When washer works, put the pipe into drain basin (as show in picture 2). Or to put the drain pipe into sewer entrance to make sure it has space between pipe mouth and sewer entrance, if not, it will influence the drainage.
3. Clean pump filter regularly to make washer works well.

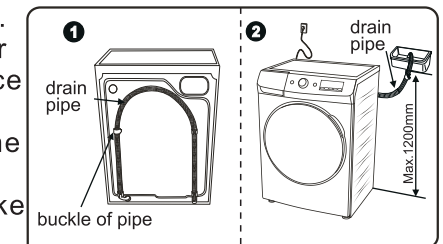

Remark: do not take out the buckle of pipe in picture 1 to avoid

NAMES AND FUNCTIONS OF CONTROL PANEL

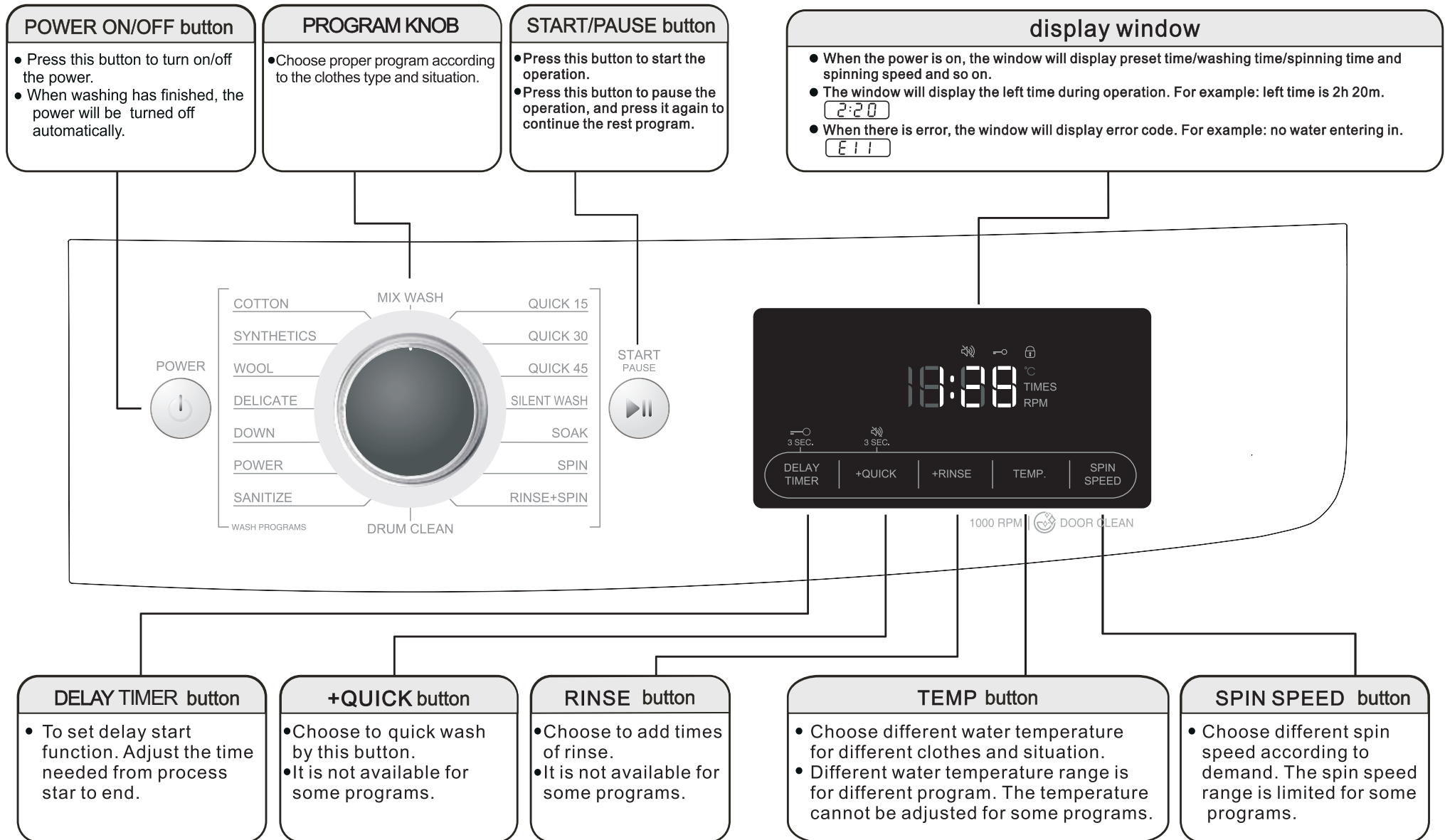

STANDARD USAGE

1.Preparation:

- Load the laundry into the washer. Close the washer door.
- Put the detergent and softener into the Detergent Case.
- Connect the Drain Hose. Connect the Water Supply Hose to the faucet and turn the faucet on. Plug the Power Cord into a socket-outlet.

2.Press the POWER button to turn the power on.

3. Turn the PROGRAM knob and choose the program your need.

4.Select desired COURSE accordingly.

5.Press the START/PAUSE button, the washer will start the washing operation.

6.At the end of operation, the buzzer will sound.

HOW TO USE THE WOOL PROGRAM

For washing delicate and woolen clothes. They shall be washed as required in the labels.

1.Preparation:

- Load the laundry into the washer. Close the washer door.
 - Put the detergent and softener into the Detergent Case.
 - Connect the Drain Hose. Connect the Water Supply Hose to the Water Tap and turn the Water Tap on. Plug the Power Cord into a socket-outlet.
-

2.Press the POWER button to turn the power on.

3.Twist the PROGRAM knob to select the WOOL program.

4.Press the START/PAUSE button, the washer will start the washing operation.

5.At the end of operation, the buzzer will sound.

- Take out the clothes in time when program ends, and hung to dry the clothes, in case the clothes become distortion.
- Do not wash with preset function.
- Water temperature should not exceed 40°C to prevent distortion.
- Wash the white or bright-colored clothes separately from the dark-colored clothes.
- Use special detergent for wool to relieve damage of clothes, and improve the wash effect.

CARE AND MAINTENANCE

When the washer be frozen

1. Wrap the faucet and Water Supply Hose joint by hot towel .
2. Dismount the Water Supply Hose and soak it into about 50°C hot water.
3. Pour into the tub about 2~3 liter 50°C hot water.
4. Link the Water Supply Hose, open the faucet and start the machine, check weather the Water Supply Hose and Drain Hose is clogged.

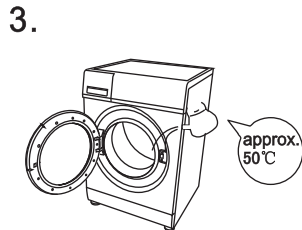
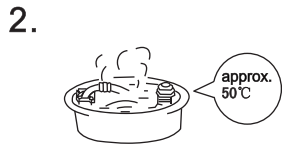
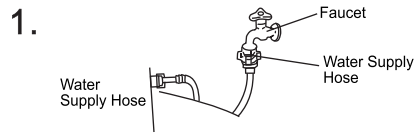

HOW TO USE THE START DELAY COURSE

The preset time means that when the washing is finished.

1. Preparation:

- Load the laundry into the washer. Close the washer door.
 - Put the detergent and softener into the Detergent Case.
 - Connect the Drain Hose. Connect the Water Supply Hose to the faucet and turn the faucet on. Plug the Power Cord into a socket-outlet.
2. Press the POWER button to turn the power on.
 3. Turn the PROGRAM knob to select the desired program course.
 4. Select the COURSE according to the use need.
 5. Touch the START DELAY button to set the finishing time of washing.
 6. Press the START/PAUSE button, the washer will start START DELAY course.
 7. At the end of operation, the buzzer will sound.

- START DELAY function could not be used for WOOL and Feathercourse.
- To change the preset time, please press POWER ON/OFF button, restart from step 2.
- To cancel the preset, press POWER ON/OFF to shut off the electrical power.
- To check the preset procedure, press START DELAY button, the washer will show you the current preset setting for 5 seconds.
- The actual ending time maybe different from the preset time as the different of water pressure, drainage, type of clothes, water temperatures, etc.
- The START DELAY light will be on after preset started one minute.

COURSE CHOOSING GUIDE

PROGRAM	WATER TEMPERATURE (°C)	SPINNING SPEED (rpm)		TOTAL TIME(min.)
		ES-FW810W ES-FWX812W	ES-FW1010W ES-FWX1014W	
Cotton	30	700	800	approx. 75 min.
Synthetics	40	700	800	approx. 65 min.
Wool	—	500	500	approx. 58 min.
Delicate	40	500	500	approx. 68 min.
Down	30	700	800	approx. 70 min.
Power	50	700	800	approx. 90 min.
Sanitize	95	700	800	approx. 75min.
Mix Wash	30	700	800	approx. 70 min.
Quick 15	20	700	800	approx. 15 min.
Quick 30	20	700	800	approx. 30 min.
Quick 45	20	700	800	approx. 45 min.
Silent Wash	40	500	500	approx. 70 min.
Soak	30	700	800	approx. 90 min.
Spin	—	700	800	approx. 10 min.
Rinse+Spin	—	700	800	approx. 15min.
Drum Clean	95	700	800	approx.133min.

NOTES

- 1.Washing time changes in different water pressure, drain situation, clothes texture, weight, temperature, etc.
- 2.The needed washing time displayed during operation could be different from the actual time needed.
- 3.As the quantity of clothes and detergents type are different, rinse result may be not ideal if the spin speed is slow. In this case, add the rinse times.
- 4.Parameter in the above chart will be different as the machine types are different.
- 5.When you select program COTTON , temperature 60°C and spin speed 500rpm, the washing time will increase automatically.

CARE AND MAINTENANCE

- Washing machine should be kept in good maintenance during long time of use. Good using habit could extend its service life.
- Pull out the plug when in maintenance, in case of electricity danger.

Washer body

- Wipe the machine body with soft clean cloth. Dip the cloth into detergents or liquid soap and then clean the machine body when there is heavy dirt on it.
- Do not pour water directly on the machine.
- Do not clean the machine body with scouring powder, diluents, gasoline, alcohol, and other chemicals.

Rubber seal on door

Wipe the dirt and debris away by towel every time after use. Remove any objects like pin from the gap of rubber seal.

Cleaning of the detergent case

- Clean the detergent case regularly in case that detergent remained in the case get mildew.
- Pull out while lift the case to carry it out, clean it by water and restore it.

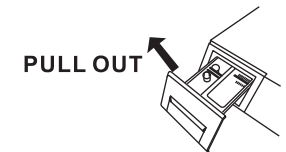

Clean the water inlet valve

(Suggest clean it every 6 months)

1. Detach the Water Supply Hose from the Water Inlet.
2. Take out the metal filter from the water inlet valve.
3. Clean the metal filter of Water Inlet with a toothbrush etc, then assemble the metal filter in the valve.
4. Connect the Water Supply Hose.
5. The lint must not to be allowed to accumulate around the washing machine (not applicable for appliances intended to be vented to the exterior of the building).

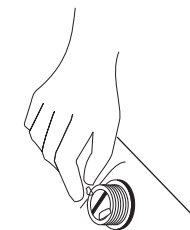

Water Inlet

Pump clean and wash (clean it every month)

1. After drain water, turn power off. Use object like coin to insert into the small gap, pull down with pressure, then open pump cover.(Note: please clean it after the water become cold if there are hot water in the machine)
- 2.Rotate and take out the pump anticlockwise.
- 3.Clean the filter.
- 4.Insert the filter by rotating clockwise and put the cover back.

Note: 1.Filter must be tighten to avoid water leakage.
2.Do not clean when machine is working.

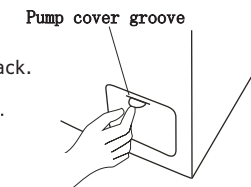

LOCK AND UNLOCK THE DOOR

Lock the door

The door will be locked automatically when the machine gets started, and the

 light will turn on at the time.

Unlock the door

When the  light is on, press START/PAUSE button, the Wash/Spin tub stop, then the door will be unlocked automatically.

- The door will be not unlocked if you directly pulled out the electrical plug.
- Foam spill over if you open the door during washing process, use towel to clean it.
- The door can not be unlocked in high temperature or high water level.

DETERGENT CASE GUIDELINES

Liquid detergent and Bleach

- Use low bubble liquid synthetic detergents.
- For concentrated liquid detergents, diluted it with water before pour into the case.

Powder detergent

- For not easily dissolve detergents, for example: powder soap bar, dissolve it in advance then pour into the case.

Softener

- Put into the case before washing, it will be poured into the tub automatically at the last round of rinse.
- For the concentrated detergents, use corresponding proportion of water to dilute it, then pour it into the case.
- Do not exceed the full mark line.

- Do not use highly concentrated washing powder or detergent.
- Use the detergent in accordance with the instruction by its manufacturer.
- Excessive detergents will cause too much bubble and affect the rinse, also create function faults.
- Choose suitable detergents in accordance with the type and color of clothes, the water temperature and the stain.

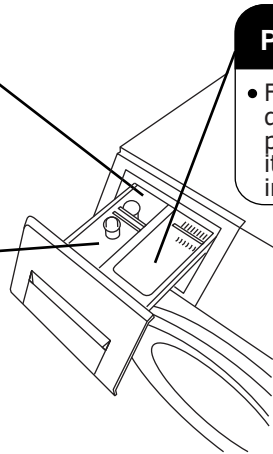

VARIOUS FUNCTIONS

CHILD LOCK FUNCTION

Child lock can be set to prevent children from misoperation during washer running. The door will be locked with child lock set.

Method of setting:

Press POWER button, and press START DELAY button for 4 seconds to set the function. Repeat the steps to cancel.

HOW TO DRAIN REMAINING WATER

After the function is set, the washer will open the drain valve to drain the remaining water out about 9 minutes after washing finishes.

Method of setting:

Press POWER button, and press SPIN SPEED button till a buzzer. Repeat the steps to cancel.

HOW TO DELETE THE END BUZZER

After setting of this function, the washer will not have end buzzer after washing finishes.

Method of setting:

Press POWER button, and press +QUICK till a buzzer. To restore, repeat the above steps.

ADDING CLOTHES MIDWAY

You can add clothes into the tub during washer running, but this function cannot be applied to RINSE course or with high water temperature.

Method of setting:

During wash process, press TEMP button for 4 seconds to set this function. After adding clothes, press the START/PAUSE button to restart washing. Before opening the door, pay attention to the water level and water temperature inside the tub, to avoid water flow out or scalding.

WASHING TIPS

- Check whether there is anything in the pockets (for example: coin, pin, clip, paper, etc).
- Zips shall be zipped close and buttons or hooks shall be fixed. The loose band or ribbon shall be bound together.
- Do not wash colored clothes together.
- Follow the washing guide printed on the clothes' mark or the symbol types of care label by the manufacturer.
- Before first washing of colored clothes use a white towel dipped in detergents to rub an uneasily discovered place of the clothes for a moment, check whether there is color on the white towel, if the color fades, be careful in washing the clothes.
- If a part of clothes is too dirty, use a towel or soft brush dipped in detergents to rub the dirty part slightly in a same direction. then put the clothes into machine.
- The machine may shock heavily in spin when there is only few clothes or single big and heavy dress, add 2~3 pieces of clothes into the tub to relieve shock.



NO TROUBLE CONDITIONS

SITUATION	REASON
The washer door can not be opened.	<ul style="list-style-type: none"> The washer is in operation Set by the child lock There is clothes caught between the seal ring and the door.
Peculiar smell.	<ul style="list-style-type: none"> Some components are made by rubber, so there may be smell of rubber.
Little water in wash and spin	<ul style="list-style-type: none"> Drum washing machine need only little water to wash clothes.
No water inflow.	<ul style="list-style-type: none"> Whether the faucet is open. Whether the Water Supply Hose be frozen. Whether the Water Supply Hose or the metal filter in water inlet be blocked.
Inflow of water during operation.	<ul style="list-style-type: none"> Water will be supplied automatically when the water level decline. Add clothes during operation.
Drainage water in during washing.	<ul style="list-style-type: none"> Whether there is too much detergents, or detergents with too much bubble.
Remaining time changes	<ul style="list-style-type: none"> If the washing clothes is in uneven distributed, water will be added to balance it. The displayed remaining time is calculated on the basis of 15 liter/minute water intake. As the water pressure will change, actual time will be prolonged or shortened accordingly. If clothes are biased in spin, the spin time will be prolonged to correct the biasing.
Abnormal sound in spin process.	<ul style="list-style-type: none"> Check if power cord contact the machine body. Check if the fixing (bolts) has been removed. Check if there are any barrettes or metal articles inside.
Program stops when power off	<ul style="list-style-type: none"> If power off , the program stops and will not continue when power on, please press the POWER ON/OFF button and re-set the program.

TROUBLE SHOOTING GUIDE

Trouble Indication	Problem	Where To Check	How to resolve the problem
	The washer does not work at all.	<ul style="list-style-type: none"> Check if the Power Cord is securely plugged in. Press the POWER ON/OFF button. Press the START/PAUSE button. Press the START DELAY button. Check whether power failure occurs. Check whether the fuse or circuit breaker has been activated. 	
E11	Water does not flow into the Wash/Spin Tub or water flow is slim.	<ul style="list-style-type: none"> Whether the faucet be opened. Whether the Water Supply Hose be frozen. Whether the Water Supply Hose or the metal filter in water inlet be blocked. Whether the water is out of supply. 	Check and resolve the problem ,then press START/PAUSE for one time to restart the washer.
E12	Water does not drain out.	<ul style="list-style-type: none"> The height of drain hose is more than 100 mm. Whether the Drain Hose is inverted. Whether the Drain Hose is blocked by scrap of fiber. Whether the Drain Hose is too long. 	Check and resolve the problem ,then press START/PAUSE for one time to restart the washer.
H	Failure of open the washer door.	<ul style="list-style-type: none"> Whether the temperature of water exceeded 40℃. Whether the temperature of water in washing process exceeded 40℃. 	The door will open automatically as soon as the temperature below 40℃.
U3	Failure of spin	<ul style="list-style-type: none"> Whether the washing machine be posited steadily. Whether the washing clothes is too big or too heavy. Whether the pieces of clothes for spin is too few. Whether the blanket be rolled into a ball. 	When the clothes is too little, add 2~3 pieces of clothes, then check the machine. Close the door, and press START/PAUSE button for one time to restart the machine.
U4	Door is not closed		Close the door with the "door lock" light on, and then press "START/PAUSE" button, the machine will run.